

Project Title: PROPOSED LUCC SITE PLAN

SITE PLAN SHOWING THE LAND OF "LANDMARK BUILDERS AND DEVELOPERS" REPRESENTED BY ONE OF ITS PARTNER SRI AJAY KUMAR SINGHANIA, S/O. LATE SHANKAR LAL AGARWAL OFFICE AT MODEL TOWN-1, PRANAMI MANDIR ROAD, SILIGURI, P. O. SEVOK ROAD, P. S. BHAKTINAGAR.

LAND AREA CALCULATION
 LAND AREA AS PER DEED = 647.49 SQM.
 LAND AREA AS PER KHATTAN = 647.49 SQM.
 LAND AREA AS PER SITE = 647.46 SQM.

SCHEDULE OF LAND
 MOUZA = SILIGURI (OLD).
 SILIGURI MADHYA PASCHIM (NEW).
 OLD J.L. NO. 110 (88), NEW J.L. NO. 90
 PLOT NO. 6075 (L.R.), 3000, 3001, 3002 (R.S.)
 KHATTAN NO. 9034 (L.R.), 332, 375 (R.S.)
 SHEET NO. 3 (R.S.)
 P.S. SILIGURI
 DIST. DARJEELING, WARD NO. 9

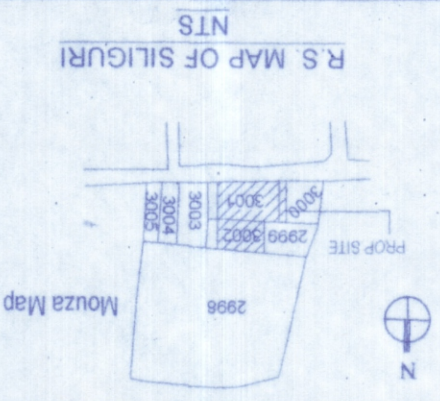

DECALARATION:
 1. I SHALL MAINTAIN 2.5 M IN FRONT OPEN SPACE
 2. I SHALL NOT CONSTRUCT STEPS IN FRONT OPEN SPACE
 ANJAYA ENTERPRISE FOOTWEAR OUTLET MALL
 DRY FRUIT STORE
 PROP. SITE

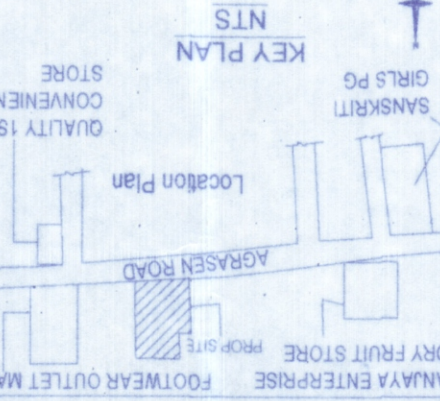

SIGNATURE OF OWNER
Landmark Builders & Developers
 Partner

SIGNATURE OF ARCHITECT
Riya Biswas (B.Arch)
 CA/2019/112919

FLOOR	PARKING AREA (SQM)	COMM AREA (SQM) (SHOP)	RESIDENTIAL AREA (SQM)	STAIR, SERVICE AREA (SQM)	TOTAL AREA (SQM)	REMARKS
GR FLOOR	129.56	158.74	30.58	318.88	837.76	PARKING, COMM (SHOP), SERVICE
1ST FLOOR	---	---	293.13	30.58	323.71	RESIDENTIAL
2ND FLOOR	---	---	293.13	30.58	323.71	RESIDENTIAL
3RD FLOOR	---	---	293.13	30.58	323.71	RESIDENTIAL
TOTAL	129.56	158.74	879.39	122.32	1290.01	

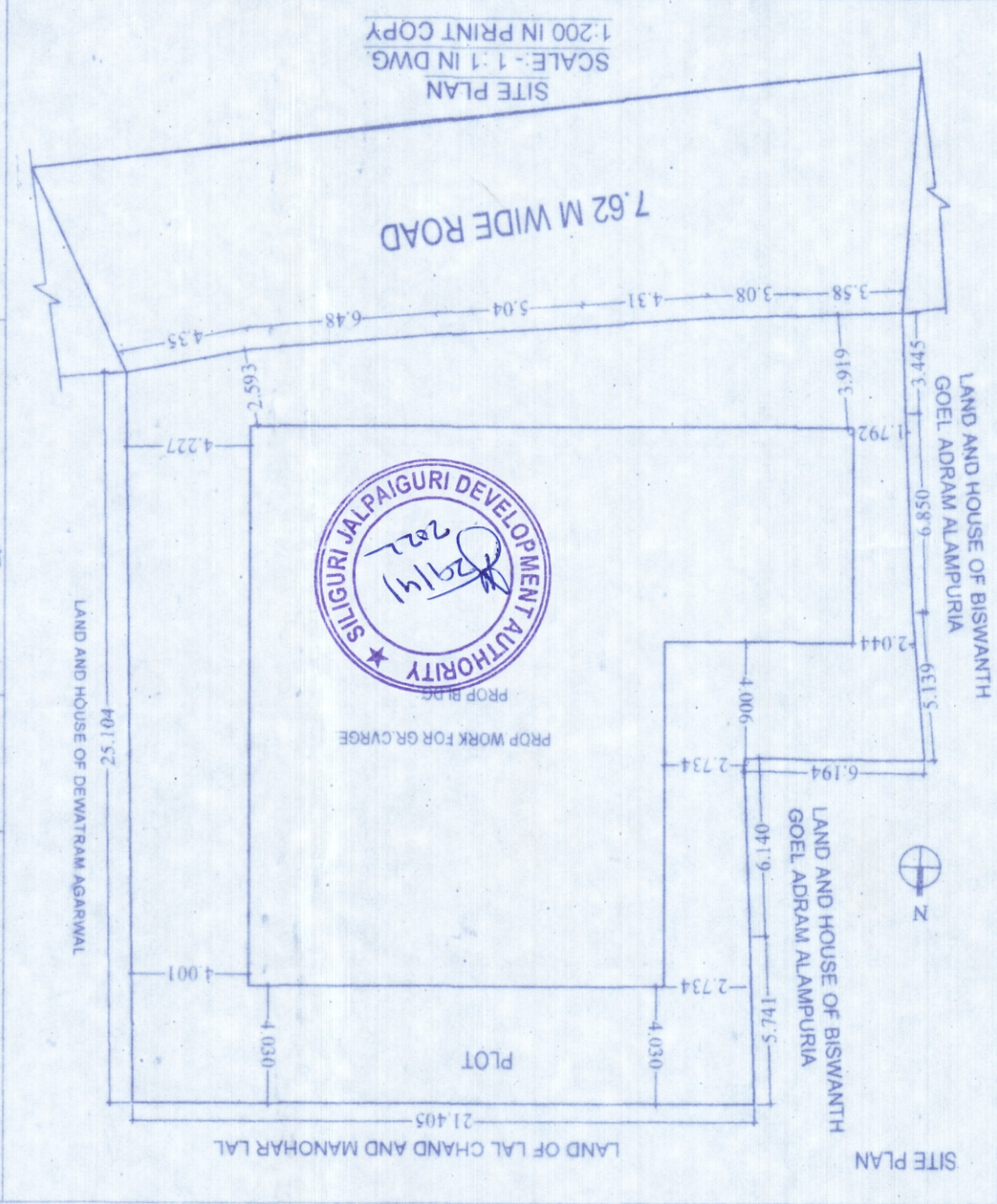

MARGIN DETAIL:

Building / Wing Name	Road Name	Front Margin	Front Pwork	Rear Margin	Rear Pwork	Side1 Margin	Side1 Pwork	Side2 Margin	Side2 Pwork	Ground Margin
PROP. BLDG.	M WIDE ROAD	7.62	---	---	---	---	---	---	---	---
---	---	2.59	---	---	---	---	---	---	---	---
---	---	2.59	---	---	---	---	---	---	---	---
---	---	4.03	---	---	---	---	---	---	---	---
---	---	4.03	---	---	---	---	---	---	---	---
---	---	1.79	---	---	---	---	---	---	---	---
---	---	1.79	---	---	---	---	---	---	---	---
---	---	4.00	---	---	---	---	---	---	---	---
---	---	4.00	---	---	---	---	---	---	---	---

COLOR INDEX:

Color Index	Description
---	ABUTTING ROAD
---	PROPOSED WORK (COVERAGE AREA)
---	EXISTING (To be retained)
---	EXISTING (To be demolished)

AREA DETAILS:

Area	Value
AREA OF PLOT (Minimum)	647.46
NET AREA OF PLOT	647.46
BALANCE AREA OF PLOT	647.46
PLOT AREA FOR COVERAGE	647.46
PLOT AREA FOR FAR	647.46
COVERAGE CHECK	647.46
Proposed Coverage Area (50.00 %%%)	323.71
Proposed Ground Coverage Area (50.00 %%%)	323.71
Total Prop. Coverage Area (50.00 %%%)	323.71
BUILT UP AREA CHECK	0.00
Total Builtup Area	0.00
ARCH / ENGG / SUPERVISOR (Regd)	---
OWNER	---
DEVELOPMENT AUTHORITY	---
LOCAL BODY	---

PROJECT DETAIL:

Item	Value
Application No.:	---
Plot Use: Residential	---
Application Type: General Proposal	---
Plot SubUse: ResiComm Bldg	---
Project Type: LUCC	---
Land Use Zone: Residential	---
Nature of Development: New	---
Location: Siliguri Urban Area	---
Plot No.: 6075 (L.R.), 3000, 3001, 3002 (R.)	---
SubLocation: Siliguri (M)	---
Sheet No.: 3	---
House No.:	---
Special Project Type: NA	---
Ward No.: 09	---
Name of Street: NA	---
Village Name: SILIGURI MADHYA PASCHIM	---
West: -	---
East: -	---

VERSION NO.: 1.0.1
 JALPAIGURI DEVELOPMENT AUTHORITY
 VERSION DATE: 30/08/2017